

TYPICAL TENNIS COURT SECTION

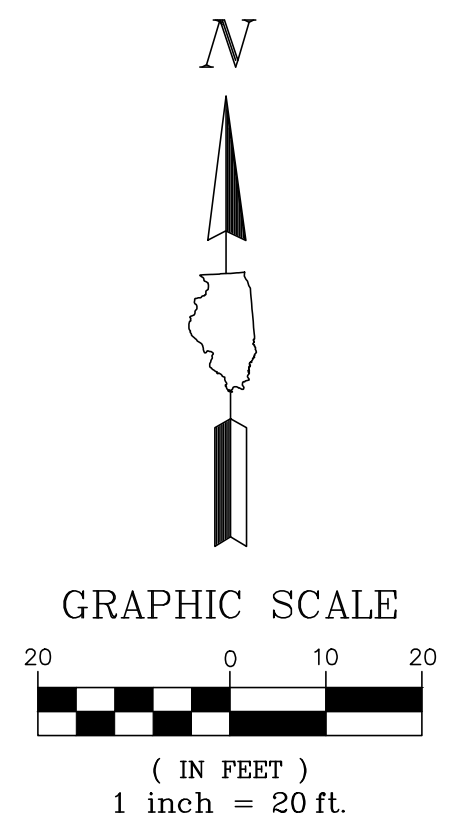

PROPOSED LEGEND

- HMA PAVEMENT
2" HMA SURFACE, N50
PETROMAT
2" HMA BINDER, N50
2"-8" ASPHALT GRINDINGS,
COMPACTED EXISTING STONE BASE
- HMA PAVEMENT
- HMA PATHWAY
- PCC PAVEMENT
- FLAT CURB, 12"
- FLAT CURB W/10' FENCE
- PAVEMENT SAWCUT
- PERIMETER EROSION BARRIER
- SLOPES
- SWALES
- OVERLAND FLOW ROUTE

GEOMETRIC AND PAVING PLAN

1. All pavement dimensions are to edge of pavement, unless otherwise noted. E=edge of pavement, B=back of curb, F=face of curb. Radii dimensions are to back of curb.
2. Install all curb and sidewalk as shown.
3. Provide 1.90% cross slope and 4.5% maximum longitudinal slope on all sidewalks and pedestrian paths unless otherwise indicated. Illinois accessibility code requires a maximum constructed cross slope of 2.00% and longitudinal slope of 5.00%.
4. Install bituminous pavement as shown. Refer to detail sheet for specific pavement sections and general note sheet for construction, testing and compaction requirements.
5. All parking lot stall markings shall be 4" Yellow point and all other parking lot pavement markings shall be paint, color as noted, in accordance with Section 780 of the IDOT Standard Specifications. (Two single applications, 16 mils each required). Site pavement marking shall be coordinated with Site engineer. Contractor shall notify site engineer 48 hrs prior to installing pavement marking.
6. For handicapped stall markings, refer to Handicapped Parking Stall and Sign Dimensioning Detail.
7. Install new signs and handicapped parking signs using 2" galvanized square tube post and telescoping post sleeve per IDOT standard.
8. Contractor shall install temporary erosion control seed and blanket as necessary to meet soil erosion and sediment control requirements. Refer to notes and details throughout the plan set for specific material requirements.
9. For final restoration, the contractor shall be responsible for restoring all disturbed turf areas and proposed turf areas as follows:
 - a. Prior to placement of topsoil restoration area subgrade material shall be rototilled and re-compacted to a maximum of 80% standard proctor to a depth of 6'.
 - b. Spread a minimum of 6' of existing site salvaged screened topsoil or new pulverized topsoil on all disturbed areas. Compact to 80% standard proctor.
 - c. Topsoil must be free of litter, brush, rocks and earth clods of greater than 1 inch in any dimension. Contain between 1%-10% organic matter, 12%-50% clay, and less than 55% sand content. pH shall be between 6.0 and 8.0.
 - d. Seed restoration areas as follows:
 - DOT Class 1 seed. (Lawn mixture)
 - Erosion control blanket shall be North American Green S75 or approved equal installed following manufacturer guidelines.
13. Once restoration has been completed, the contractor shall remove erosion control devices. Silt fence trenches shall be backfilled and restored in kind. Storm structures shall be cleaned of debris.

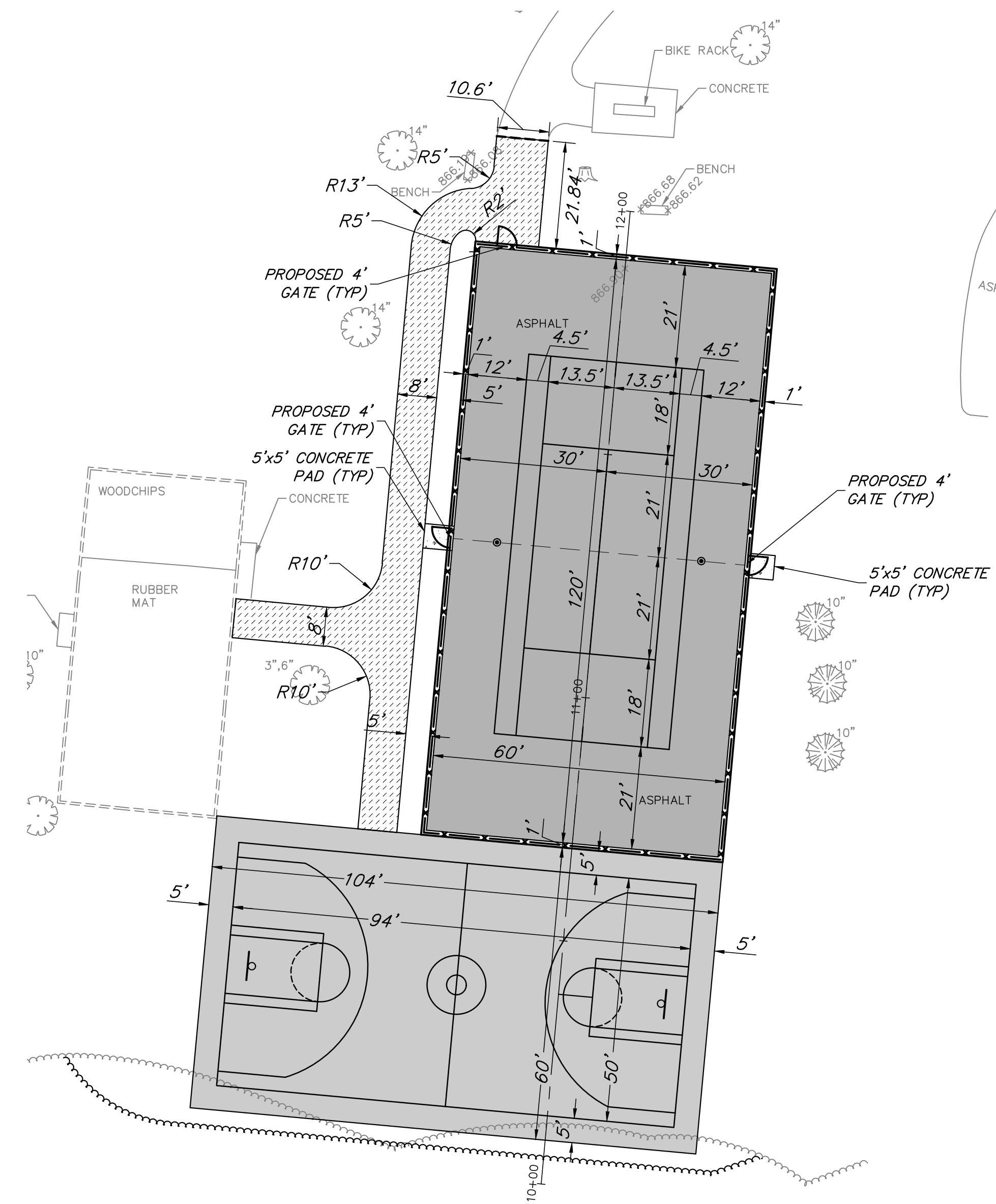

PROPOSED GEOMETRIC PLAN

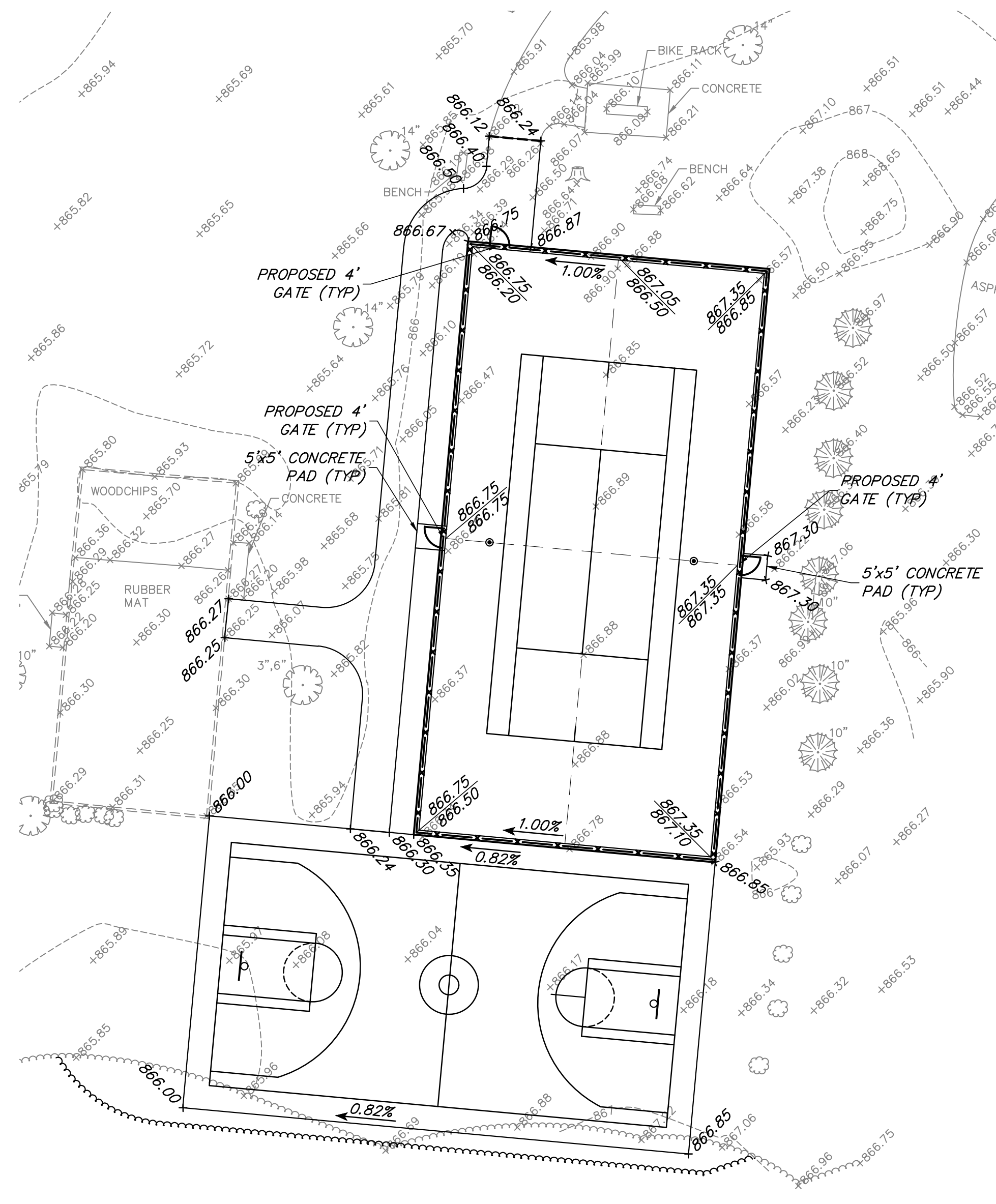

PROPOSED GRADING PLAN

GHA GEWALT HAMILTON ASSOCIATES, INC.
625 Forest Edge Drive ■ Vernon Hills, IL. 60061
TEL 847.478.9700 ■ FAX 847.478.9701

COPYRIGHT NOTICE
This drawing is the property of Gewalt-Hamilton Assoc., Inc. and is not to be used for any purpose other than the specific project and site named herein, and cannot be reproduced in any manner without the express written permission from Gewalt-Hamilton Associates, Inc.

PROPOSED IMPROVEMENTS
WYNDWOOD PARK
CRYSTAL LAKE PARK DISTRICT
CRYSTAL LAKE, ILLINOIS

NO.	BY	DATE	REVISION

FILE: 4129_268_Wyndwood_PR1.dwg	SHEET NUMBER:
DRAWN BY: ALC	GHA PROJECT #
DATE: 08/20/18	4129.268
CHECKED BY: TAR	SCALE:
DATE: 08/20/18	1"=20'
	OF — SHEETS
	3